

S.02

SH 02

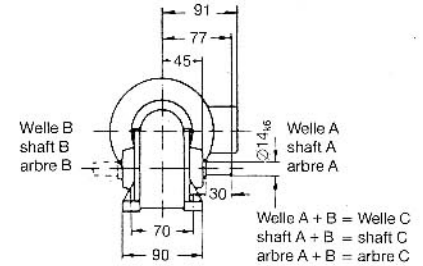

SV 02

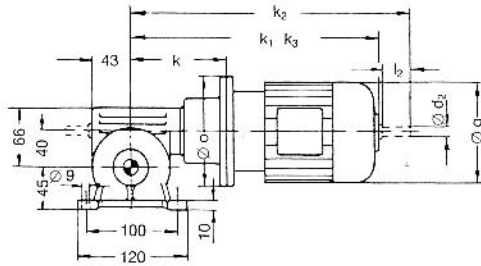
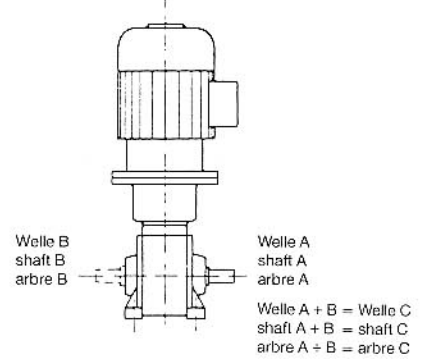
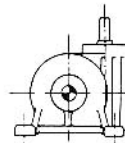
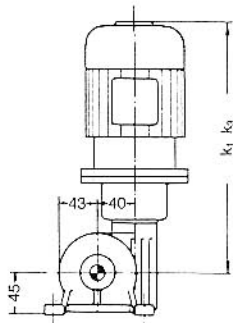

SF 02

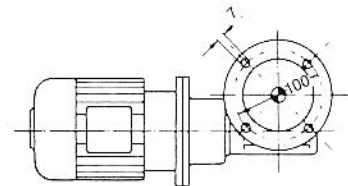
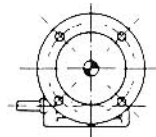
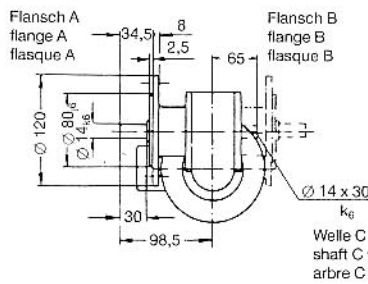

SAD 02

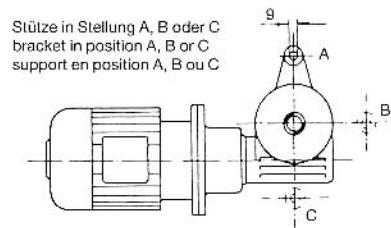
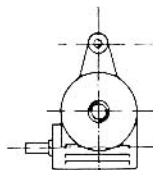
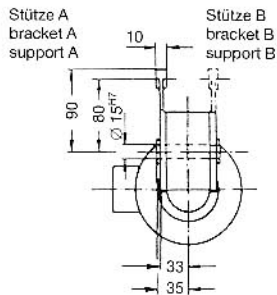

SAF 02

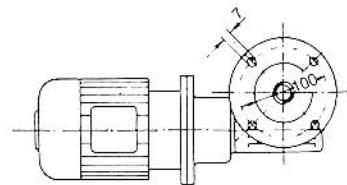
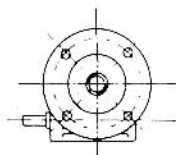
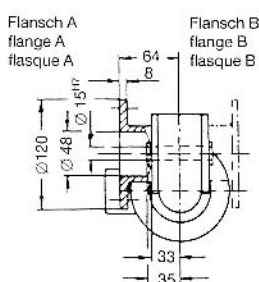

¹⁾ Nur für Bremsmotoren
For brakemotors only
Seulement pour moteurs-frein

²⁾ Motoren K und N haben gleiche Abmessungen
Motors K and N have the same dimensions
Dimensions identiques pour moteurs K et N

Wellen bis $\varnothing 45$ mm nach ISO k6, über $\varnothing 45$ mm ISO m6
Zentrierung nach DIN 332 ab M5
Paßfedern nach DIN 6885/1

Shafts acc. ISO k6 up to $\varnothing 45$ mm, ISO m6 over $\varnothing 45$ mm
Shaft with tapped centre bore acc. to DIN 332 from M5
Keys and keyways acc. to DIN 6885 sheet 1

Arbres exécutés suivant tolérance ISO k6 jusqu'à $\varnothing 45$ mm
tolérance ISO m6 plus de $\varnothing 45$ mm
Perçage et taraudage de l'arbre suivant DIN 332 de M5
Rainures de clavette et clavettes suivant DIN 6885 pg 1

Motor-Typ	d ₂	g	g ₁	k	k ₁	k ₂	k ₃ ¹⁾	l ₂	o
56 N ²⁾	9	111	100	102	269	293	303	20	120
63 N ²⁾	11	123	106	102	290	318	348	23	120
71 N ²⁾	11	138	115	113	325	353	386	23	140
80 N ²⁾	14	156	130	123	357	393	429	30	120